

G2 MULTI TUBULAR HEAT EXCHANGER

The unique design and robust construction of the G2 Heat Exchanger offers an unrivalled heat transfer surface area, making it one of the most efficient products on the market.



FEATURES

- Four models ranging from 30-kW to 122-kW
- Titanium tube bundle
- BS 316L Stainless Steel primary casing
- Salt and sea water compatible
- 4 bar pressure tolerance
- Low pressure drop
- With optional Smart Touchscreen Controller and Booster Pump
- Temperature and flow sensor port
- Floor or wall mountable

TECHNICAL DRAWINGS

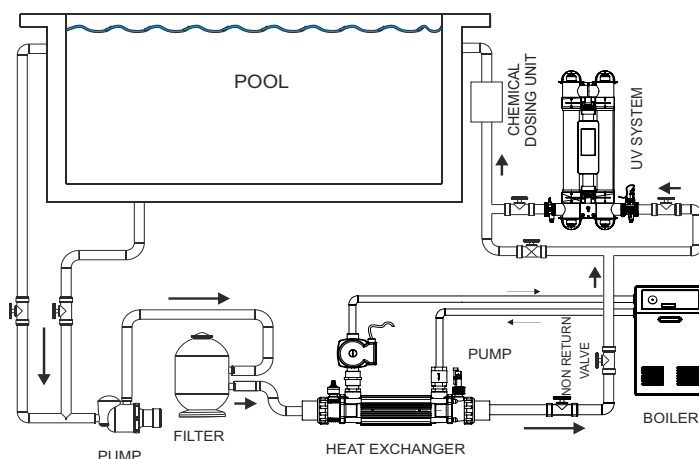
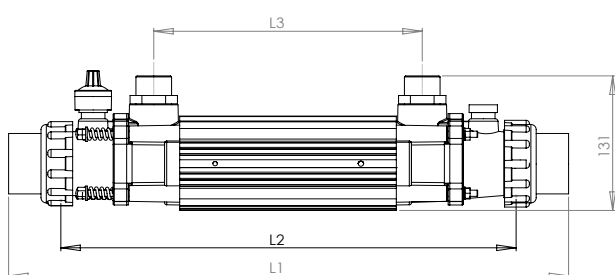

PRESSURE DROP

PRESSURE DROP PRIMARY CIRCUIT

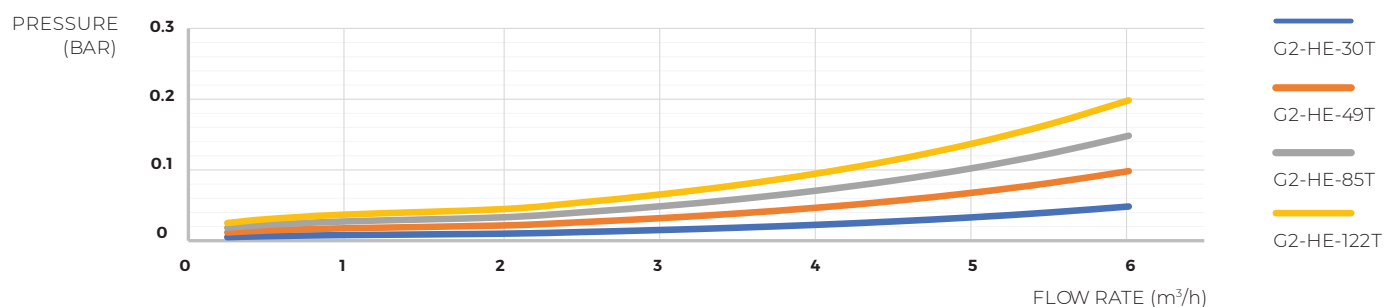

PRESSURE DROP SECONDARY CIRCUIT

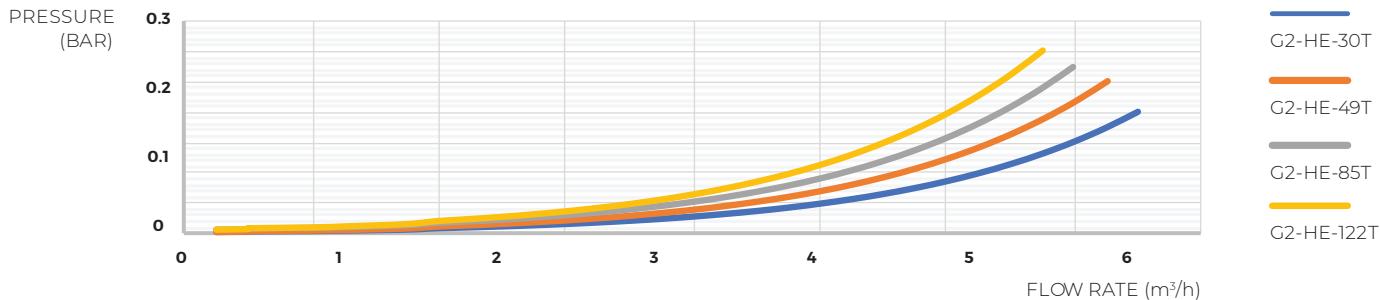

SPECIFICATIONS

PRIMARY CIRCUIT

FLOW TUBE	BS 316L stainless steel tube
WATER CONNECTIONS	1" BSP male fittings
WORKING PRESSURE	4 bar maximum

SECONDARY CIRCUIT

FLOW TUBE	Bundle of 37 titanium tubes
WATER CONNECTIONS	1½" / 50mm stepped ABS unions for rigid pipe connection
WORKING PRESSURE	4 bar maximum

MODELS

PRODUCT CODES	STANDARD POWER OUTPUT	DIMENSION 'L1'	DIMENSION 'L2'	DIMENSION 'L3'	NET WEIGHT	GROSS WEIGHT	VOLUME
		mm	mm	mm	kg	kg	m³
G2-HE-30T	30-kW (102K BTU)	540	426	247	3.5	3.9	0.016
G2-HE-49T	49-kW (167K BTU)	710	596	417	4.5	5.0	0.021
G2-HE-85T	85-kW (290K BTU)	840	726	547	5.3	6.3	0.026
G2-HE-122T	122-kW (416K BTU)	1000	886	707	6.4	7.6	0.037

STANDARD OUTPUT	PRIMARY FLOW m³/h	PRIMARY PRESSURE LOSS Bar	SECONDARY FLOW m³/h	SECONDARY PRESSURE LOSS Bar	ΔT 15°C kW	ΔT 20°C kW	ΔT 30°C kW	ΔT 40°C kW	ΔT 50°C kW	ΔT 60°C kW	ΔT 70°C kW
30-kW	1.1	0.061	10	0.050	9	11	16	20	26	30	33
30-kW	1.3	0.068	10	0.050	10	13	18	23	31	34	39
30-kW	1.3	0.068	14	0.070	11	15	20	26	34	41	46
49-kW	1.6	0.077	16	0.092	13	18	25	43	41	50	56
49-kW	1.8	0.083	16	0.092	15	20	28	38	45	55	62
49-kW	2.2	0.093	17	0.098	16	22	33	44	52	64	73
85-kW	2.4	0.113	17	0.106	22	28	40	53	64	75	81
85-kW	2.7	0.129	17	0.106	26	32	46	60	73	82	89
85-kW	3.2	0.147	17	0.106	28	34	49	64	77	90	102
122-kW	3.8	0.183	19	0.126	33	43	68	75	93	108	120
122-kW	4.2	0.200	19	0.126	36	48	70	89	108	126	143
122-kW	4.6	0.211	19	0.126	38	53	73	95	116	137	156